

**FARE**

Food Allergy Research &amp; Education

**FOOD ALLERGY & ANAPHYLAXIS EMERGENCY CARE PLAN**

Name: \_\_\_\_\_ D.O.B.: \_\_\_\_\_

Allergy to: \_\_\_\_\_

Weight: \_\_\_\_\_ lbs. Asthma: ☐ Yes (higher risk for a severe reaction) ☐ No**PLACE  
PICTURE  
HERE****NOTE: Do not depend on antihistamines or inhalers (bronchodilators) to treat a severe reaction. USE EPINEPHRINE.****Extremely reactive to the following foods:** \_\_\_\_\_**THEREFORE:**

- ☐ If checked, give epinephrine immediately for ANY symptoms if the allergen was likely eaten.
- ☐ If checked, give epinephrine immediately if the allergen was definitely eaten, even if no symptoms are noted.

**FOR ANY OF THE FOLLOWING:****SEVERE SYMPTOMS****LUNG**Short of breath,  
wheezing,  
repetitive cough**HEART**Pale, blue,  
faint, weak  
pulse, dizzy**THROAT**Tight, hoarse,  
trouble  
breathing/  
swallowing**MOUTH**Significant  
swelling of the  
tongue and/or lips**SKIN**Many hives over  
body, widespread  
redness**GUT**Repetitive  
vomiting, severe  
diarrhea**OTHER**Feeling  
something bad is  
about to happen,  
anxiety, confusion**OR A  
COMBINATION**  
of symptoms  
from different  
body areas.

- 1. INJECT EPINEPHRINE IMMEDIATELY.**
- 2. Call 911.** Tell them the child is having anaphylaxis and may need epinephrine when they arrive.
  - Consider giving additional medications following epinephrine:
    - » Antihistamine
    - » Inhaler (bronchodilator) if wheezing
  - Lay the person flat, raise legs and keep warm. If breathing is difficult or they are vomiting, let them sit up or lie on their side.
  - If symptoms do not improve, or symptoms return, more doses of epinephrine can be given about 5 minutes or more after the last dose.
  - Alert emergency contacts.
  - Transport them to ER even if symptoms resolve. Person should remain in ER for at least 4 hours because symptoms may return.

**MILD SYMPTOMS****NOSE**Itchy/runny  
nose,  
sneezing**MOUTH**

Itchy mouth

**SKIN**A few hives,  
mild itch**GUT**Mild nausea/  
discomfort**FOR MILD SYMPTOMS FROM MORE THAN ONE  
SYSTEM AREA, GIVE EPINEPHRINE.****FOR MILD SYMPTOMS FROM A SINGLE SYSTEM  
AREA, FOLLOW THE DIRECTIONS BELOW:**

- Antihistamines may be given, if ordered by a healthcare provider.
- Stay with the person; alert emergency contacts.
- Watch closely for changes. If symptoms worsen, give epinephrine.

**MEDICATIONS/DOSES**

Epinephrine Brand: \_\_\_\_\_

Epinephrine Dose: ☐ 0.15 mg IM ☐ 0.3 mg IM

Antihistamine Brand or Generic: \_\_\_\_\_

Antihistamine Dose: \_\_\_\_\_

Other (e.g., inhaler-bronchodilator if wheezing): \_\_\_\_\_

PARENT/GUARDIAN AUTHORIZATION SIGNATURE

DATE

PHYSICIAN/HCP AUTHORIZATION SIGNATURE

DATE



**FARE**  
Food Allergy Research & Education

# FOOD ALLERGY & ANAPHYLAXIS EMERGENCY CARE PLAN

## EPIPEN® (EPINEPHRINE) AUTO-INJECTOR DIRECTIONS

1. Remove the EpiPen Auto-Injector from the plastic carrying case.
2. Pull off the blue safety release cap.
3. Swing and firmly push orange tip against mid-outer thigh.
4. Hold for approximately 10 seconds.
5. Remove and massage the area for 10 seconds.

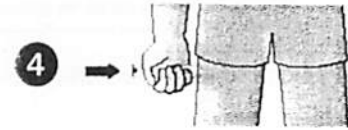
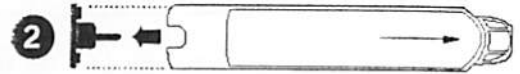

## ADRENALINE®/ADRENALINE® GENERIC DIRECTIONS

1. Remove the outer case.
2. Remove grey caps labeled "1" and "2".
3. Place red rounded tip against mid-outer thigh.
4. Press down hard until needle penetrates.
5. Hold for 10 seconds. Remove from thigh.

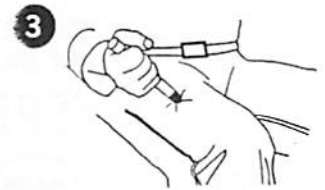
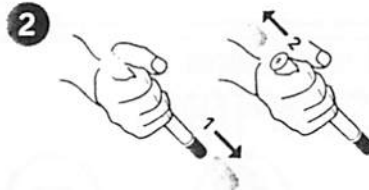

**OTHER DIRECTIONS/INFORMATION** (may self-carry epinephrine, may self-administer epinephrine, etc.):

Treat the person before calling emergency contacts. The first signs of a reaction can be mild, but symptoms can get worse quickly.

### EMERGENCY CONTACTS — CALL 911

RESCUE SQUAD: \_\_\_\_\_

DOCTOR: \_\_\_\_\_ PHONE: \_\_\_\_\_

PARENT/GUARDIAN: \_\_\_\_\_ PHONE: \_\_\_\_\_

### OTHER EMERGENCY CONTACTS

NAME/RELATIONSHIP: \_\_\_\_\_

PHONE: \_\_\_\_\_

NAME/RELATIONSHIP: \_\_\_\_\_

PHONE: \_\_\_\_\_

PARENT/GUARDIAN AUTHORIZATION SIGNATURE \_\_\_\_\_

DATE \_\_\_\_\_